



# HOSHIZAKI



## FEATURES

- | specially designed high-pressure pump installed assured with Hoshizaki's highest standards
- | uniquely designed parts to maximise performance yet are easily detachable for cleaning or maintenance
- | stable output of high temperature water for an efficient wash

DISHWASHER MACHINE

### HIGH PERFORMANCE



#### HIGH ACHIEVER

Its Triple Long Arm nozzle reaches nooks and corners

#### HIGH TEMP

stable water temperature when needed

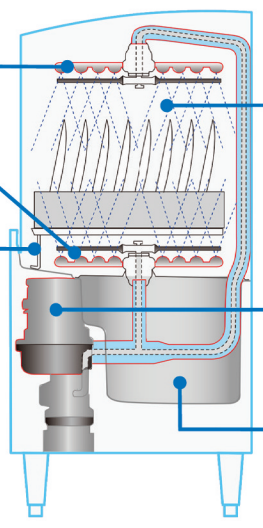

#### WATER SPRAY



#### HIGH QUALITY

Hoshizaki's renowned quality high pressure pump installed

#### HIGH CAPACITY

high water volume storage

### EASY TO CLEAN AND MAINTAIN

Parts are easily detachable to make cleaning a snap. No special or tools needed!

Its rounded edges reduces stain and dirt traps within the tank.

Parts are designed symmetrically to fit both sides



Parts are detachable for easy cleaning



### AND IT IS DURABLE!

- Stringent endurance test of 1 million door swings
- Robust and high quality stainless steel used



### CLEAN UP QUICKLY

Normal Mode  
1 Cycle  
**60 seconds**

<b>Washing</b> 48s Water 60°C	<b>Dwell</b> 5s	<b>Rinsing</b> 6s Water 85°C	<b>Dwell</b> 1s
-------------------------------------	--------------------	------------------------------------	--------------------

Long Mode  
1 Cycle  
**120 seconds**

<b>Washing</b> 108s Water 60°C	<b>Dwell</b> 5s	<b>Rinsing</b> 6s Water 85°C	<b>Dwell</b> 1s
--------------------------------------	--------------------	------------------------------------	--------------------

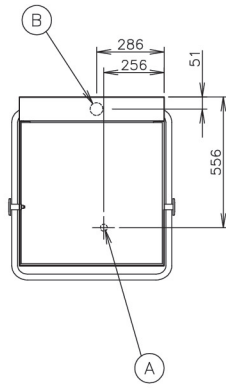

NO	CONNECTION	SPECIFICATION
A	DISHWASHER WATER SUPPLY	G3/4
B	WASH TANK DRAIN	Drain Hose 45mm DIA x 39mm DIA 2000mm long outside
C	POWER CORD	2800mm long outside (with Earth Wire, No Plug)

RACK SUPPORT FRAME LAYOUT  
STRAIGHT INSTALLATION

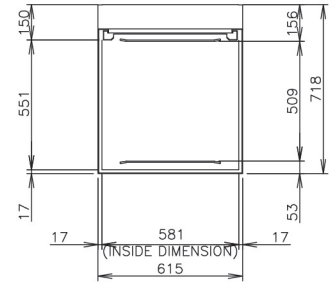

RACK SUPPORT FRAME LAYOUT  
CORNER INSTALLATION

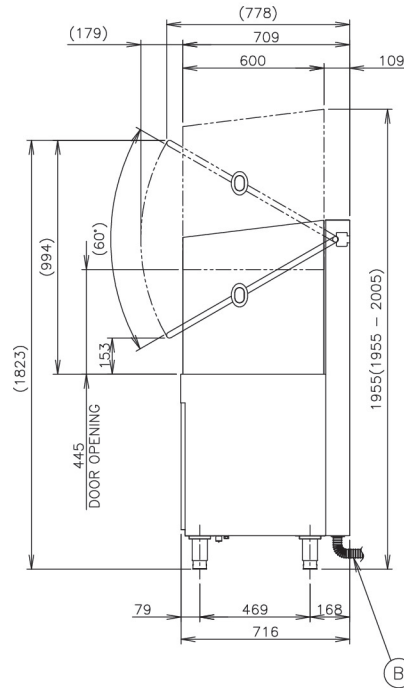
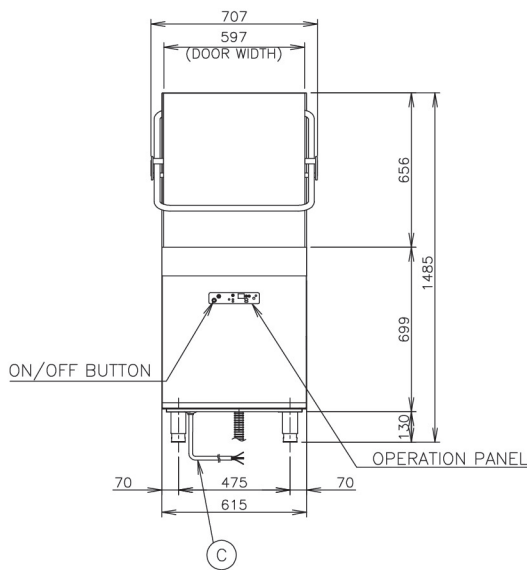
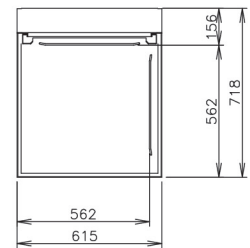

Model Name	HW-600A
Water consumption	2.0 L / rack
Water supply	Direct connection to water main 15°C (5 - 80°C)
Washing capacity	60 / 40 racks / h
Wash tank heater	3.0 kW
Booster tank heater	12.0 kW
Wash pump	710W / 1 Phase
Rinse pump	95W / 1 Phase
Wash tank capacity	22 L
Dimensions (mm)	W 615 x D 718 x H 1,485 (1,485-1,535)
Rack size (mm)	500 X 500
Power supply	3 Phase 4 Wire 380V 50Hz
Electric consumption	16.0kW
Door opening height	445 mm
Detergent / rinse aid feeder	Provided by detergent supplier
Drain pump model	Customized

**FUN  
FOOD  
THAILAND**

**Professional Kitchen  
EQUIPMENT SUPPLIERS**  
" For all your Kitchen "



THAI: +66 (0)98 398 9770  
ENG: +66 (0)62 420 9203  
Santisuk Soi 3, Pattaya City,  
Bang Lamung District, Chon Buri 20150

www.funfoodthailand.com